

0 10 20 30 40 50 60 70 80 90 100 110 120 130 140 150 160 170 180 190 200 210 220 230 240 250 260 270 280 290 300 310 320 330 340 350 360 370 380 390 400 410 420 430 440 450 460 470 480 490 500 510 520 530 540 550 560 570 580 590 600 610 620 630 640 650 660 670 680 690 700 710 720 730 740 750 760 770 780 790 800 810 820 830 840 850 860 870 880 890 900 910 920 930 940 950 960 970 980 990 1000

**GENERAL NOTES:**  
 1. THE WORKLOADS ON PAVED DRIVE RW. 100'-0" EQUALS CUSTOMER RW. 88'-0".  
 2. PAVER PLOT IS EQUIPPED WITH 6" REBAR CONC. EXCEPT WHERE OTHERWISE NOTED.  
 3. [Symbol] INDICATES ACCESS ROADS (ASPHALT) PAVED.  
 4. PAVING DEPTH ON STATION RW. IS 6" FOR ASPHALT.  
 5. [Symbol] INDICATES PAVED WITH ASPHALT.  
 6. [Symbol] INDICATES LIGHTING PAVEMENT FLANKSTRIPS.  
 7. [Symbol] INDICATES LIGHTING PAVEMENT FLANKSTRIPS.  
 8. DISTRIBUTION OF YARD COLUMNS IS SYMBOLIC AND DOES NOT REPRESENT THEIR ACTUAL POSITION.

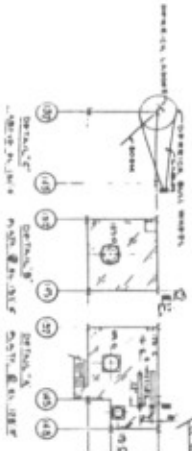
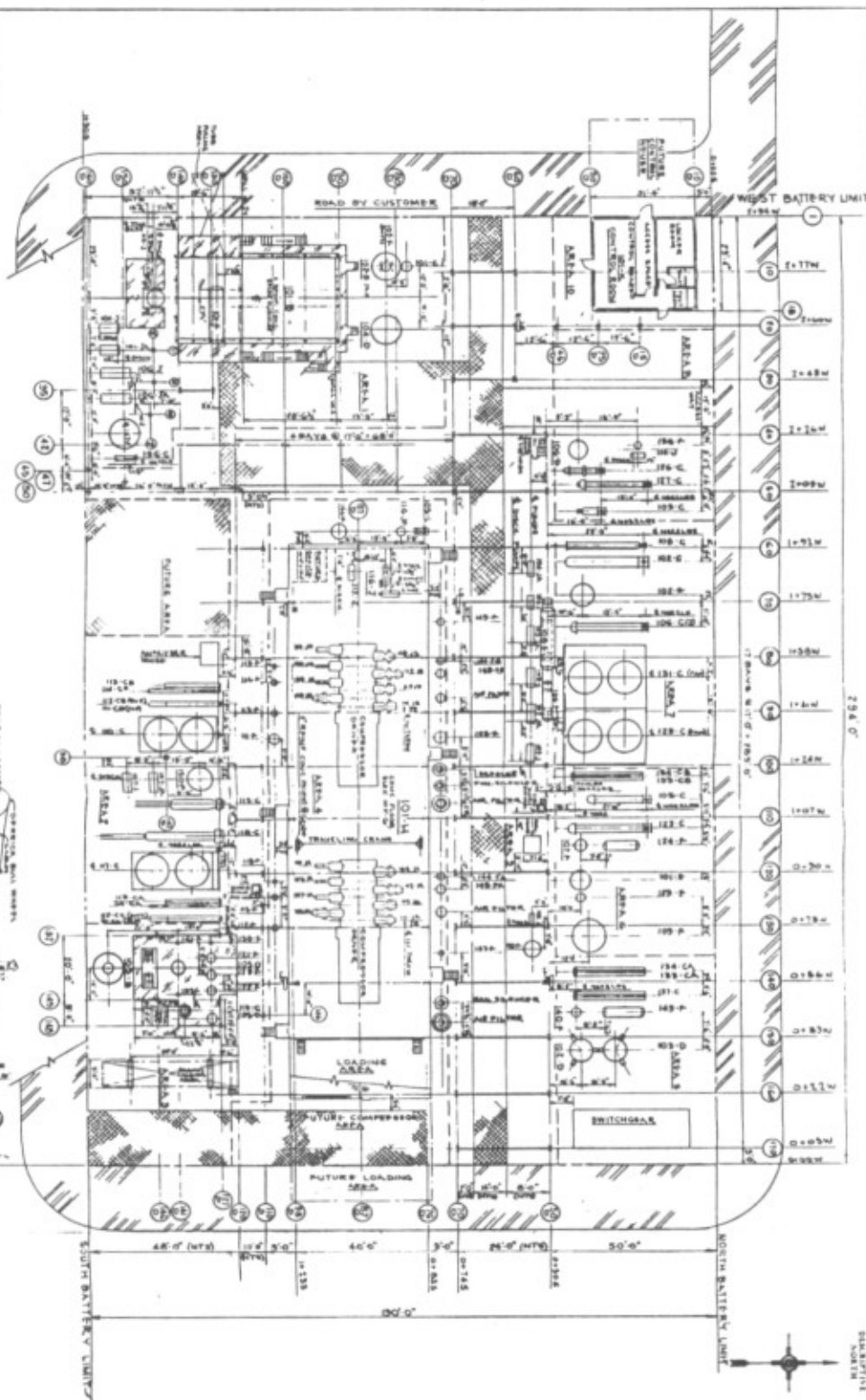

NO.	DESCRIPTION	DATE	BY	CHECKED
1	ISSUED FOR PERMITTING	10/1/50	W. W. KELLOGG	J. H. [unclear]
2	ISSUED FOR CONSTRUCTION	10/1/50	W. W. KELLOGG	J. H. [unclear]
3	ISSUED FOR [unclear]	10/1/50	W. W. KELLOGG	J. H. [unclear]
4	ISSUED FOR [unclear]	10/1/50	W. W. KELLOGG	J. H. [unclear]
5	ISSUED FOR [unclear]	10/1/50	W. W. KELLOGG	J. H. [unclear]
6	ISSUED FOR [unclear]	10/1/50	W. W. KELLOGG	J. H. [unclear]
7	ISSUED FOR [unclear]	10/1/50	W. W. KELLOGG	J. H. [unclear]
8	ISSUED FOR [unclear]	10/1/50	W. W. KELLOGG	J. H. [unclear]
9	ISSUED FOR [unclear]	10/1/50	W. W. KELLOGG	J. H. [unclear]
10	ISSUED FOR [unclear]	10/1/50	W. W. KELLOGG	J. H. [unclear]

**THE M. W. KELLOGG CO.**  
 100 BATTERY ROAD  
 NEW BRUNSWICK, N. J.  
 5086  
 6101

NO.	DESCRIPTION	DATE	BY	CHECKED
1	ISSUED FOR PERMITTING	10/1/50	W. W. KELLOGG	J. H. [unclear]
2	ISSUED FOR CONSTRUCTION	10/1/50	W. W. KELLOGG	J. H. [unclear]
3	ISSUED FOR [unclear]	10/1/50	W. W. KELLOGG	J. H. [unclear]
4	ISSUED FOR [unclear]	10/1/50	W. W. KELLOGG	J. H. [unclear]
5	ISSUED FOR [unclear]	10/1/50	W. W. KELLOGG	J. H. [unclear]
6	ISSUED FOR [unclear]	10/1/50	W. W. KELLOGG	J. H. [unclear]
7	ISSUED FOR [unclear]	10/1/50	W. W. KELLOGG	J. H. [unclear]
8	ISSUED FOR [unclear]	10/1/50	W. W. KELLOGG	J. H. [unclear]
9	ISSUED FOR [unclear]	10/1/50	W. W. KELLOGG	J. H. [unclear]
10	ISSUED FOR [unclear]	10/1/50	W. W. KELLOGG	J. H. [unclear]

**LIST OF EQUIPMENT**  
 1. [unclear]  
 2. [unclear]  
 3. [unclear]  
 4. [unclear]  
 5. [unclear]  
 6. [unclear]  
 7. [unclear]  
 8. [unclear]  
 9. [unclear]  
 10. [unclear]  
 11. [unclear]  
 12. [unclear]  
 13. [unclear]  
 14. [unclear]  
 15. [unclear]  
 16. [unclear]  
 17. [unclear]  
 18. [unclear]  
 19. [unclear]  
 20. [unclear]  
 21. [unclear]  
 22. [unclear]  
 23. [unclear]  
 24. [unclear]  
 25. [unclear]  
 26. [unclear]  
 27. [unclear]  
 28. [unclear]  
 29. [unclear]  
 30. [unclear]  
 31. [unclear]  
 32. [unclear]  
 33. [unclear]  
 34. [unclear]  
 35. [unclear]  
 36. [unclear]  
 37. [unclear]  
 38. [unclear]  
 39. [unclear]  
 40. [unclear]  
 41. [unclear]  
 42. [unclear]  
 43. [unclear]  
 44. [unclear]  
 45. [unclear]  
 46. [unclear]  
 47. [unclear]  
 48. [unclear]  
 49. [unclear]  
 50. [unclear]  
 51. [unclear]  
 52. [unclear]  
 53. [unclear]  
 54. [unclear]  
 55. [unclear]  
 56. [unclear]  
 57. [unclear]  
 58. [unclear]  
 59. [unclear]  
 60. [unclear]  
 61. [unclear]  
 62. [unclear]  
 63. [unclear]  
 64. [unclear]  
 65. [unclear]  
 66. [unclear]  
 67. [unclear]  
 68. [unclear]  
 69. [unclear]  
 70. [unclear]  
 71. [unclear]  
 72. [unclear]  
 73. [unclear]  
 74. [unclear]  
 75. [unclear]  
 76. [unclear]  
 77. [unclear]  
 78. [unclear]  
 79. [unclear]  
 80. [unclear]  
 81. [unclear]  
 82. [unclear]  
 83. [unclear]  
 84. [unclear]  
 85. [unclear]  
 86. [unclear]  
 87. [unclear]  
 88. [unclear]  
 89. [unclear]  
 90. [unclear]  
 91. [unclear]  
 92. [unclear]  
 93. [unclear]  
 94. [unclear]  
 95. [unclear]  
 96. [unclear]  
 97. [unclear]  
 98. [unclear]  
 99. [unclear]  
 100. [unclear]